

TP19UD24B

DC

> CONTACT US



TP series roof exhaust units represent an optimal solution for heat dissipation through the top of electrical cabinets. They are ideal for indoor use where there is limited space on the front and side panels. According to the ambient conditions these units can operate with fan (forced air) or without a fan (natural air convection).

Technical data		
APPROVALS		
Approvals	CE; UKCA	
PERFORMANCE		
Max Airflow	613	m³/h
	361	CFM
Airflow with Exhaust Filter	560	m³/h
	330	CFM
Max Static Pressure	444	Pa
	1.78	in H2O
ELECTRICAL DATA		
Tachometer Output	3	pulse/revolution
Rated Voltage	24	V d.c.
Rated Current	3.99	A
Rated Power	95	W
Operating Voltage	16-28	V d.c.
Motor Protection	Electronically Protected	
GENERIC DATA		
Weight	2.41	Kg
	5.32	lb
RAL Number	7035	
Electrical Connection	Terminal Block	

Image is for illustrative purpose only. All specifications, data and drawing are subject to change without notice. Please refer to our terms of sales including our warranty and limited liabilities clauses.

TP19UD24B

DC

> CONTACT US

VENTILATION SYSTEMS

Technical data		
Life Expectancy	20000	h at 55 °C
	20000	h at 131 °F
Wires Section	1-4	mm²
Wires Section	16-12	AWG
Fan Noise	63.0	dB(A)
Filter Class	G2	EN 779
Filter Class	ISO coarse 30%	ISO 16890
ENVIRONMENTAL AND THERMAL DATA		
IP Protection Degree	IP24	
Operating Temperature	-20÷55	°C
	-4÷131	°F
Storage Temperature	-25÷60	°C
	-13÷140	°F

Image is for illustrative purpose only. All specifications, data and drawing are subject to change without notice. Please refer to our terms of sales including our warranty and limited liabilities clauses.

TP19UD24B

DC

> CONTACT US

VENTILATION SYSTEMS

Technical drawing mm (in)

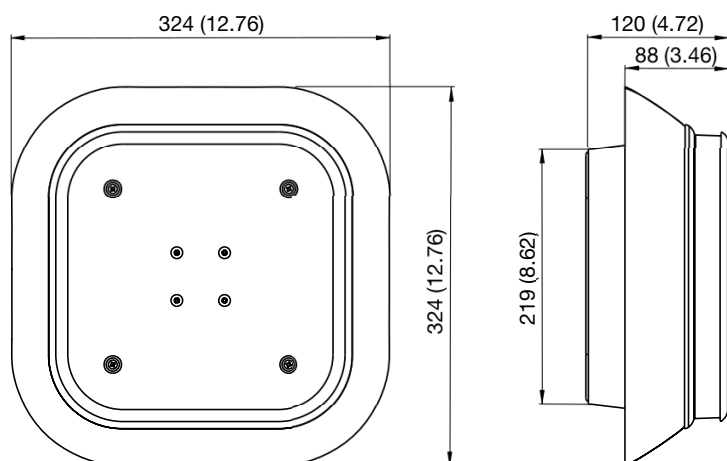

Mounting cut-out mm (in)

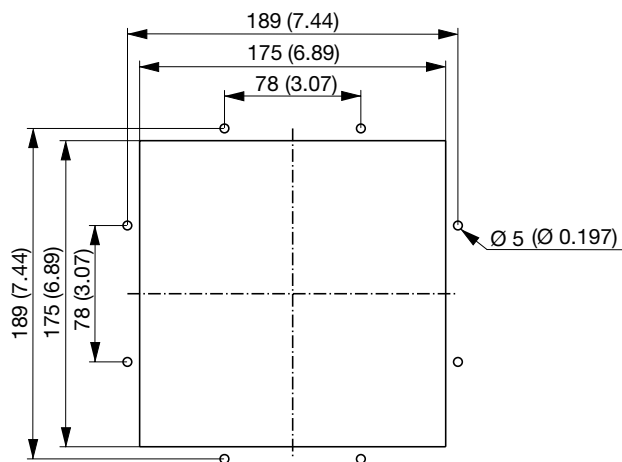

Image is for illustrative purpose only. All specifications, data and drawing are subject to change without notice. Please refer to our terms of sales including our warranty and limited liabilities clauses.

TP19UD24B

DC

> CONTACT US

Wiring diagram

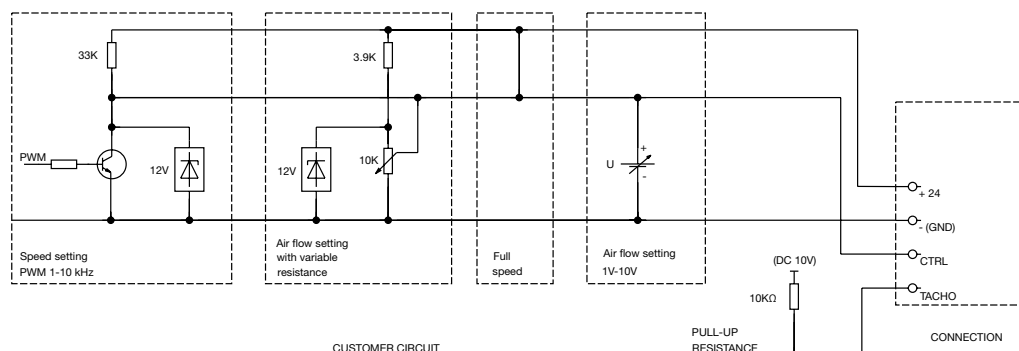

Air performance

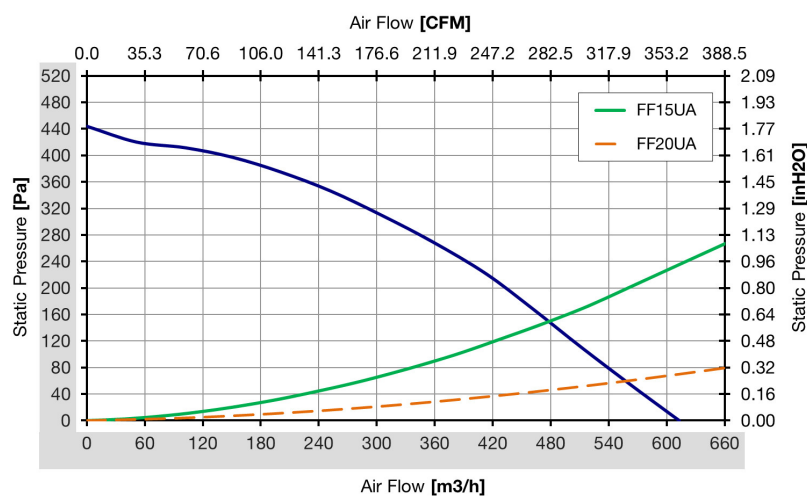

Image is for illustrative purpose only. All specifications, data and drawing are subject to change without notice. Please refer to our terms of sales including our warranty and limited liabilities clauses.